

# Advanced Condensing Combination Boiler

## Optimum Efficiency

**28 kW  
HIGH DOMESTIC  
HOT WATER FLOW RATE  
COMBI**

**PROGRAMMABLE  
7 DAY DIGITAL TIMER**

# CSI 85 (T) 780 Series



**11.0 LITRES FLOW RATE  
@ 35°C RISE**

# Energy Efficient Savings

Ravenheat have been manufacturing boilers for over 20 years, and are known for producing products with high energy efficiency, combined with the introduction of new technologies. The CSI 85 (780) Series is the latest edition to our current range of reliable, cost effective, high performance condensing combi boilers.

The oval shape control panel is a distinguishing feature, stylish and easy to clean with integrated side panels. Dimensions of the boiler measures only 310 (D) x 770 (H) x 450mm (W).

**We only use high quality components from leading industry manufacturers: Honeywell, Grundfos and Giannoni.**

## Flue Options (sold separately)

The CSI 85 (780) requires a standard 1 metre horizontal flue kit, or a vertical flue accessory kit which can be extended to 2.5 metres horizontal or 3.5 metres vertical. The flue arrangements should fit most requirements however; alternative systems (twin or 125mm) are available for longer flue distances on request.

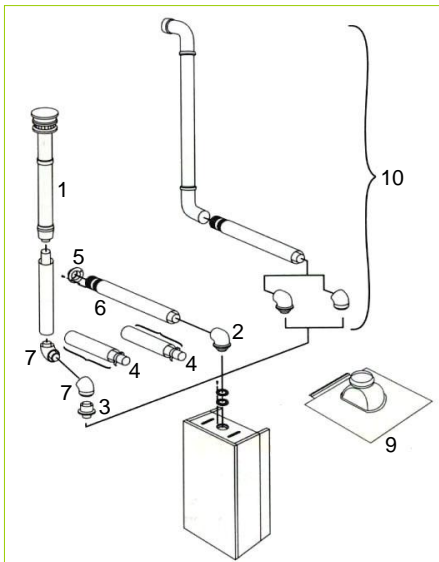

## Quality

Built to exacting ISO 9001 standards using quality components, all our boilers carry the European CE mark. Each Ravenheat appliance undergoes a rigorous testing and operating procedure before being carefully packed for maximum protection, ready to leave our factory.

## Modern instrument panel with easy to set user controls for greater energy savings

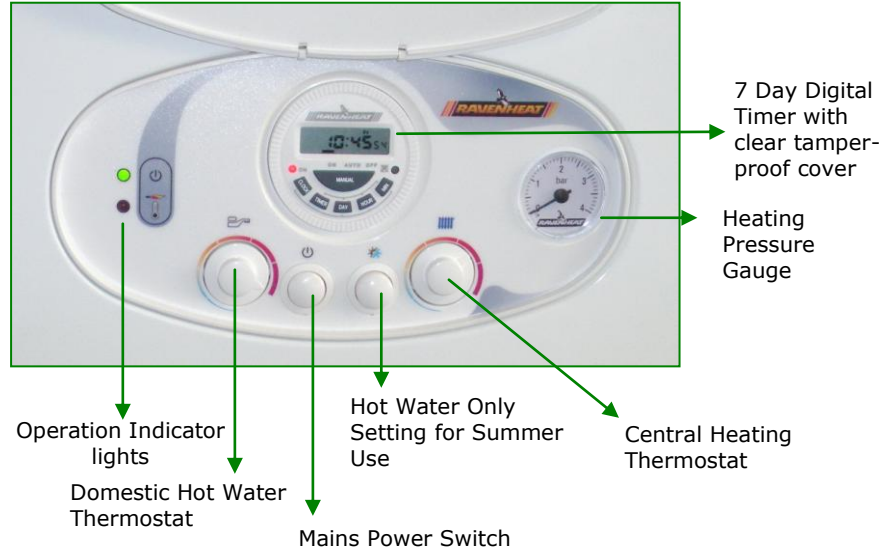

## 100mm Concentric Flue System

PART	DESCRIPTION	BARCODE	RAVENHEAT PART NO
1 + 3	Vertical flue terminal kit + straight flue header (vertical starter pack)	5060022141995 + 5060022141186	N5094130 + 5094110B
2	90 deg boiler bend	5060022141209	CSIFB
3	Straight flue header	5060022141186	5094110B
4	1000mm flue extension	5060022141339	NFE Supplied with No 6
5	External flue collar		
6	Horizontal flue kit complete with boiler bend	5060022141230	CSIFKB
7	45 deg in line bend	5060022141247	N45FBI
7	90 deg inline bend	5060022141315	N90FBI
9	Vertical lead flashing sleeve – pitched roof	5060022141063	0019TEG06005/0
10	Plume kit	5060022143142	1019TER11010/0

## Easily installed neat connections



## Enjoy the benefits:

- Low cost hot water & central heating
- Fuel efficiency guarantees low emissions
- Factory fitted mains lead
- 100% Function tested
- Reduced heating bills by up to 35%
- Designed and manufactured in accordance with ISO 9001
- Inbuilt automatic bypass
- Frost protection
- Inbuilt 7 day digital timer/programmer
- Inbuilt condensing trap
- 1 Year guarantee
- Available in Nat gas

## Boiler Specifications

Model: CSI 85 (T) 780

Central heating max-min nett input	kW	24.8 – 13
Output	kW	24.0 – 10.6
Domestic hot water max-min		
Input	kW	26.0 – 11.6
Output condensing	kW	28.0 – 13.7
Domestic hot water		
Flow rate raised 30°C Δ t	l/min	13.2
35°C Δ t	l/min	11.0
Expansion vessel	1	7/1
Max central heating temperature	°C	85°
Connection		
Heating flow & return compression	mm	22
Gas connection	mm	15
Domestic supply (cold) compression	mm	15
Domestic supply (hot) compression	mm	15
Condensing pipe ¾ push fit overflow pipe		
Flue size	mm	100
Electrical mains supply		230V 50Hz Fused 3amp
SEDBUK Band B <b>B</b> Nat Gas		88%
Note: (T) denotes product with timer		Yes
Built in by-pass		Yes
Dimensions		310 (D) x 770 (H) x 450mm (W).



CHARTISTS WAY, MORLEY, LEEDS, LS27 9ET

TELEPHONE: 0113 252 7007 FAX: 0113 238 0229

WEBSITE: [WWW.RAVENHEAT.CO.UK](http://WWW.RAVENHEAT.CO.UK) E-MAIL: [SALES@RAVENHEAT.CO.UK](mailto:SALES@RAVENHEAT.CO.UK)